

3.7 FLAT BAR CARRIER

Cable carrier systems for working environments with heavy dust and dirt buildup. Also ideal for monorail and curved applications as the flatbar rail can be manipulated on site.

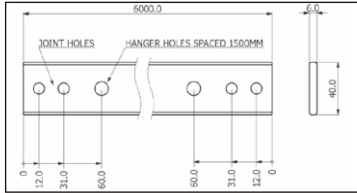

- FLAT BAR**
 3-FB46/0100 40 x 6 x 6m Mild steel flat bar
 3-FB56/0100 50 x 6 x 6m Mild steel flat bar
 3-FB68/0100 60 x 8 x 6m Mild steel flat bar
 3-FBS46/0100 40 x 6 x 6m Stainless steel flat bar

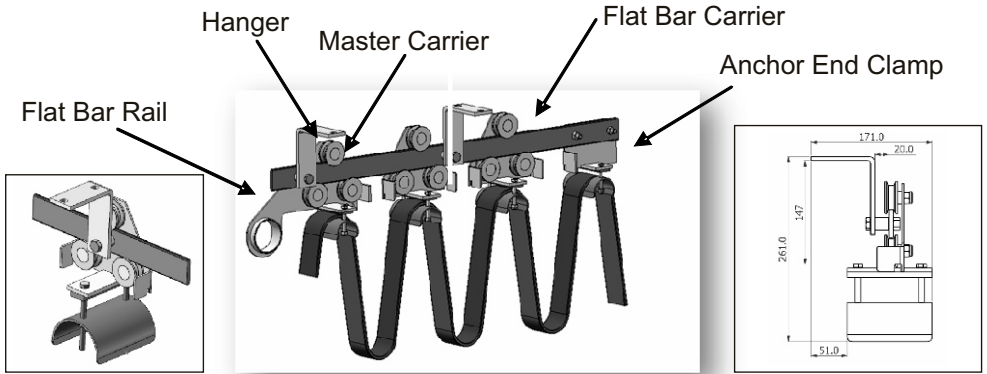
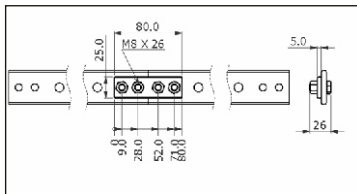

- FLAT BAR UNIVERSAL JOINT**
 3-FB/0200 Joint section universal
 3-FBS/0200 Joint section universal S/S

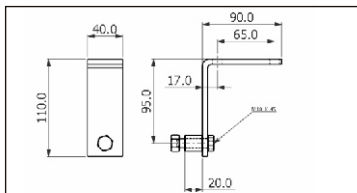

- FLAT BAR HANGER & OFFSET SPACER**
 3-FB/0300 Universal Support Hanger
 3-FBS/0300 Universal Support Hanger S/S

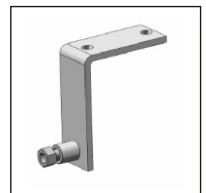

- FLAT BAR END STOP UNIVERSAL**
 3-FB/0400 End stop
 3-FBS/0400 End stop S/S



3.7 FLAT BAR CARRIER

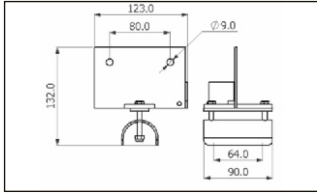

FLAT BAR ANCHOR DOME UNIVERSAL

3-FBM/0520	Medium duty Anchor
3-FBH/0530	Heavy duty Anchor
3-FBMS/0520	Medium duty Anchor S/S
3-FBHS/0530	Heavy duty Anchor S/S

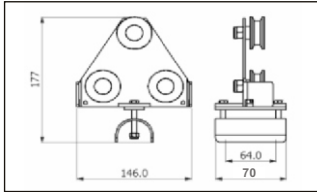
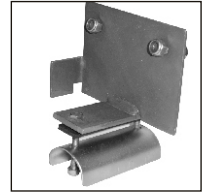

FLAT BAR 40X6 CARRIER MEDIUM DUTY

3-FBM46/0620	Mild steel Carrier Galvanized
3-FBMS46/0620	Stainless steel Carrier

FLAT BAR 50X6 CARRIER MEDIUM DUTY

3-FBM56/0620	Mild steel Carrier Galvanized
3-FBMS56/0620	Stainless steel Carrier

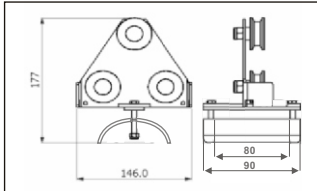

FLAT BAR 40X6 CARRIER HEAVY DUTY

3-FBH46/0630	Mild steel Carrier Galvanized
3-FBHS46/0630	Stainless steel Carrier

FLAT BAR 50X6 CARRIER HEAVY DUTY

3-FBHS56/0630	Mild steel Carrier Galvanized
---------------	-------------------------------

FLAT BAR 60X8 CARRIER HEAVY DUTY

3-FBM46/0630	Mild steel Carrier Galvanized
--------------	-------------------------------

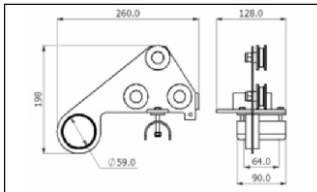

FLAT BAR 40X6 MASTER CARRIER MEDIUM DUTY

3-FBM46/0720	Mild steel Master Carrier Galvanized
3-FBMS46/0730	Stainless steel Master Carrier

FLAT BAR 50X6 MASTER CARRIER HEAVY DUTY

3-FBH56/0730	Mild steel Master Carrier Galvanized
--------------	--------------------------------------

FLAT BAR 60X8 MASTER CARRIER HEAVY DUTY

3-FBH56/0730	Mild steel Master Carrier Galvanized
--------------	--------------------------------------

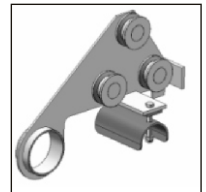

Flat Bar system also available in Stainless Steel

Options on application

1. Dust proof bearing caps are available for wheels
2. Other flat bar sizes available on application
3. Stainless steel bearings on application
4. Heavy Duty four wheel carriers also available on request

Note - For support brackets, see page 19.

- When designing a festoon system, the ambush area/parking area must be taken into account.
- Min bending radius = 1000mm
- Support bracket spacing every 0,5 m for curves.